

## DETAILS

<b>Product Number</b>	CA13688_STRADA-SQ-T3
<b>Family</b>	Strada
<b>Type</b>	Assembly
<b>Color</b>	clear
<b>Diameter</b>	25 x 25 mm
<b>Height</b>	8,4 mm
<b>Style</b>	square
<b>Optic Material</b>	PMMA
<b>Holder Material</b>	
<b>Fastening</b>	pin, tape
<b>Status</b>	production ready
<b>ROHS Compliant</b>	Yes
<b>Date Updated</b>	21/09/2016



## OPTICAL PROPERTIES

LED	Viewing	Light	Effi-	cd/lm	Connector
	Angle	Beam	ciency		
PSL440	Asymmetric deg	Asymmetric	92 %	0.730	-
MK-R	sim: Asymmetric	Asymmetric	sim: 90 %	sim: 0.550	-
MHB-A	sim: Asymmetric	Asymmetric	-	-	-
XHP50	Asymmetric deg	Asymmetric	94 %	0.710	-
LUXEON M/MX	Asymmetric deg	Asymmetric	92 %	0.500	-
LUXEON MZ	asymmetric deg	Asymmetric	91 %	0.840	-
LUXEON TX	Asymmetric deg	Asymmetric	93 %	1.100	-
LUXEON XR-M linear 1x3, 1x4, 1x5	Asymmetric deg	Asymmetric	93 %	0.530	-
NV4x144A	Asymmetric deg	Asymmetric	91 %	0.550	-
NVSxx19B/NVSxx19C	sim: Asym	Asymmetric	sim: 90 %	-	-
Duris S10	Asymmetric deg	Asymmetric	92 %	0.590	-
Duris P10	sim: Asymmetric	Asymmetric	sim: 89 %	sim: 0.640	-
Duris P8	sim: Asym	Asymmetric	sim: 91 %	sim: 0.780	-

4

3

2

1

4

3

2

1

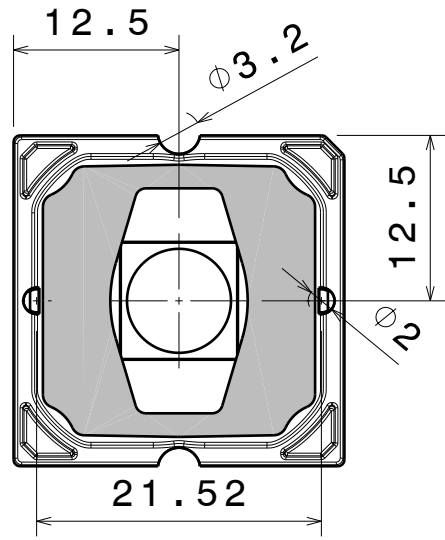

c / c Bottom view

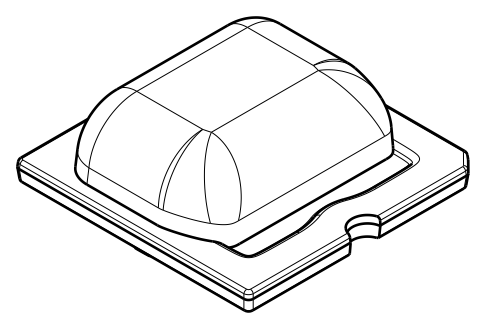

Isometric view

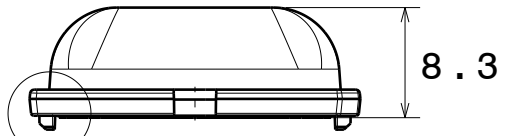

Front view

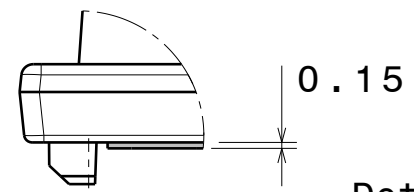

Detail B

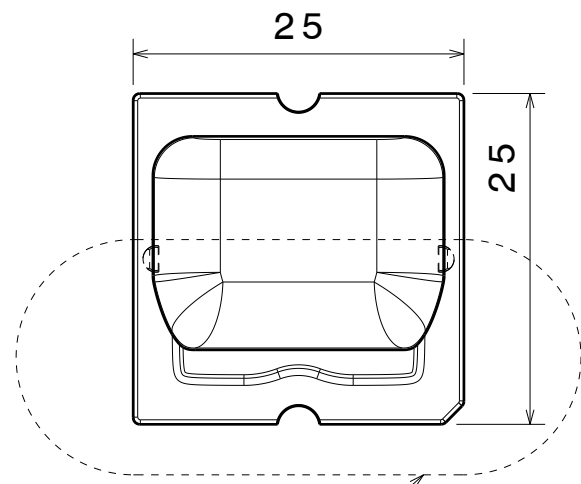

Beam direction Top view

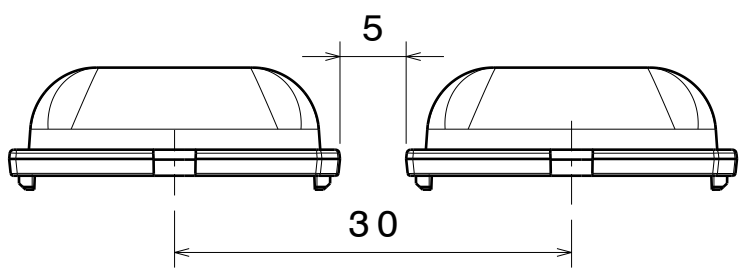

Minimum spacing c / c

Tolerances if not otherwise shown  
 According to DIN ISO 2768-1  
 Linear measures:  
 Up to 30mm class M, otherwise class C.  
 According to DIN ISO 2768-2  
 Form and position: class L

**LEDiL** LediL Oy  
 Salorankatu 10  
 FIN 24240 SALO  
 Finland

THIRD ANGLE PROJECTION:

DRAWING TITLE  
**STRADA-SQ-T3 Datasheet**

This drawing is the property of LEDiL Oy. It may not be reproduced, copied or communicated without a written agreement with LEDiL Oy."

SIZE	PART NUMBER		
A4	-		

SCALE	7:4	WEIGHT	-	SHEET	1/1
-------	-----	--------	---	-------	-----

D

A

Luminaire: LEDiL Oy CA13688\_STRADA-SQ-T3\_(PSL440)  
Lamps: 1 x Citizen\_PSL440\_256.951lm@250mA\_P=2.8697W\_I=0.250A

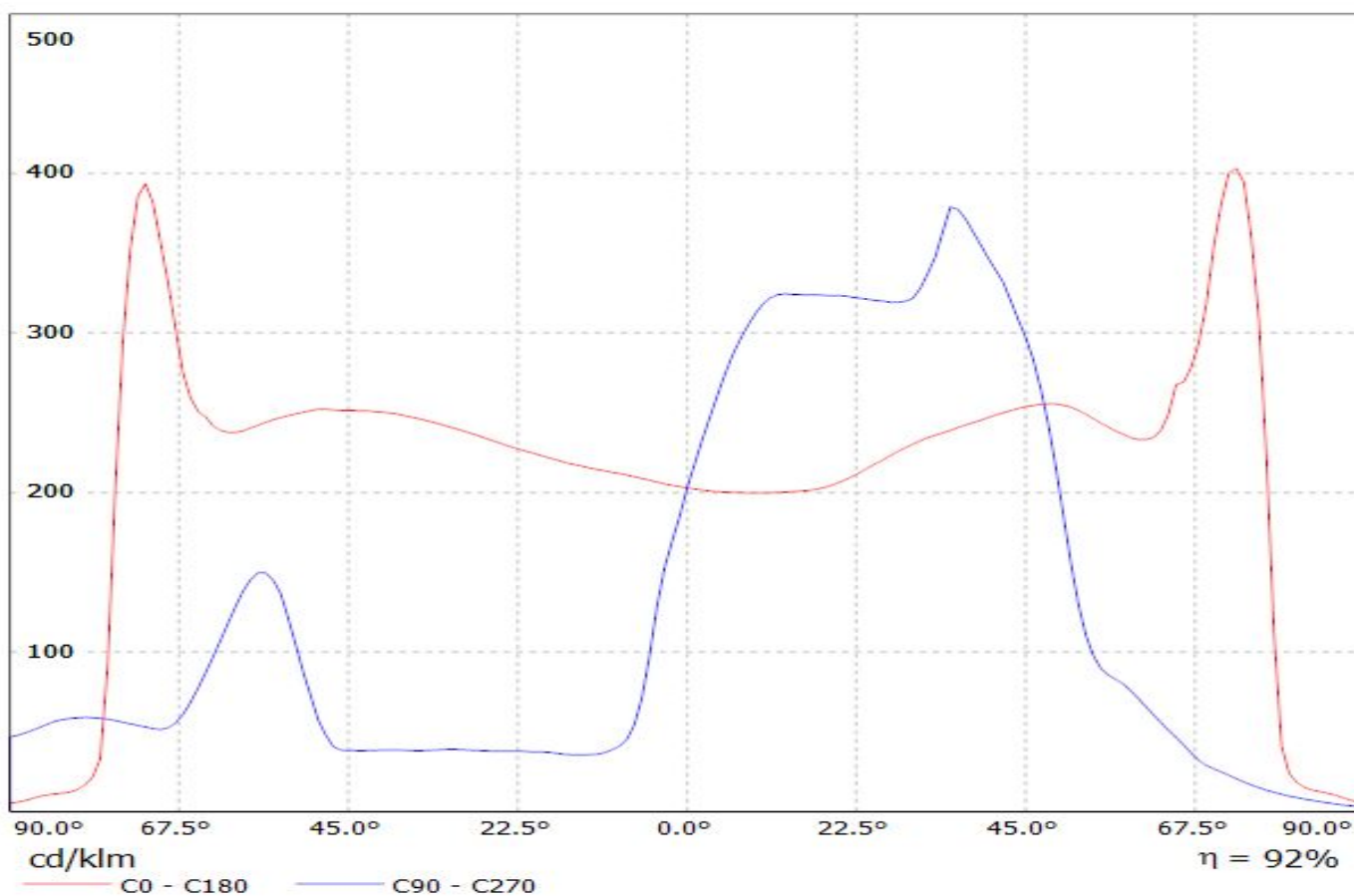

Luminaire: LEDiL Oy CA13688\_STRADA-SQ-T3\_(CREE\_XHP50\_COOLWHITE)  
Lamps: 1 x CREE\_XHP50\_COOLWHITE\_242.798@0.250A\_P=1.42658W\_I=0.2499A

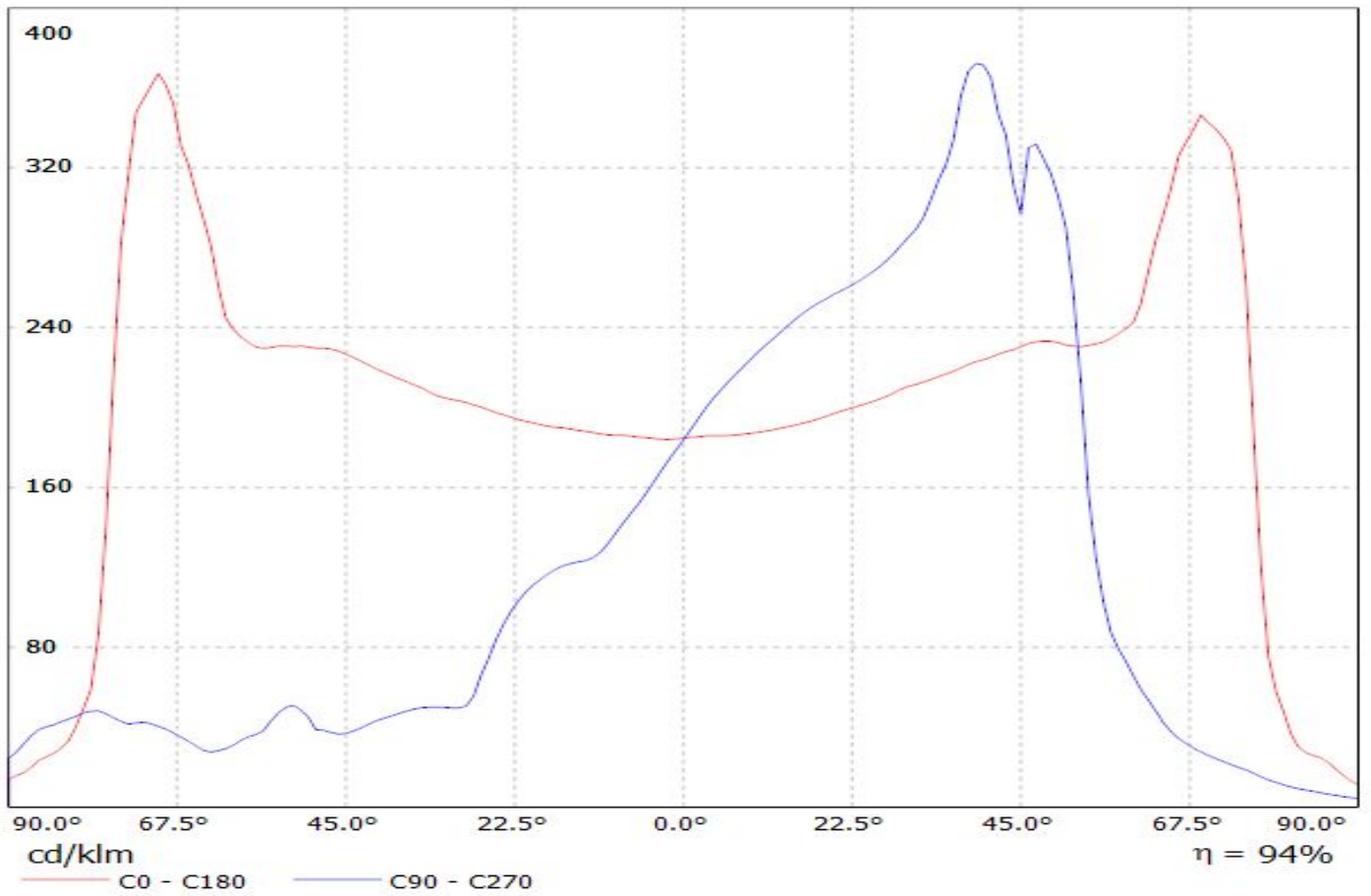

# LEDiL Oy CA13688\_STRADA-SQ-T3\_(LUXEON\_M) Eff.91.7% / LDC (Linear)

Luminaire: LEDiL Oy CA13688\_STRADA-SQ-T3\_(LUXEON\_M) Eff.91.7%  
Lamps: 1 x LUXEON\_M\_350.373lm@250mA\_CCT=4092K\_P=2.73116W\_I=249.9mA

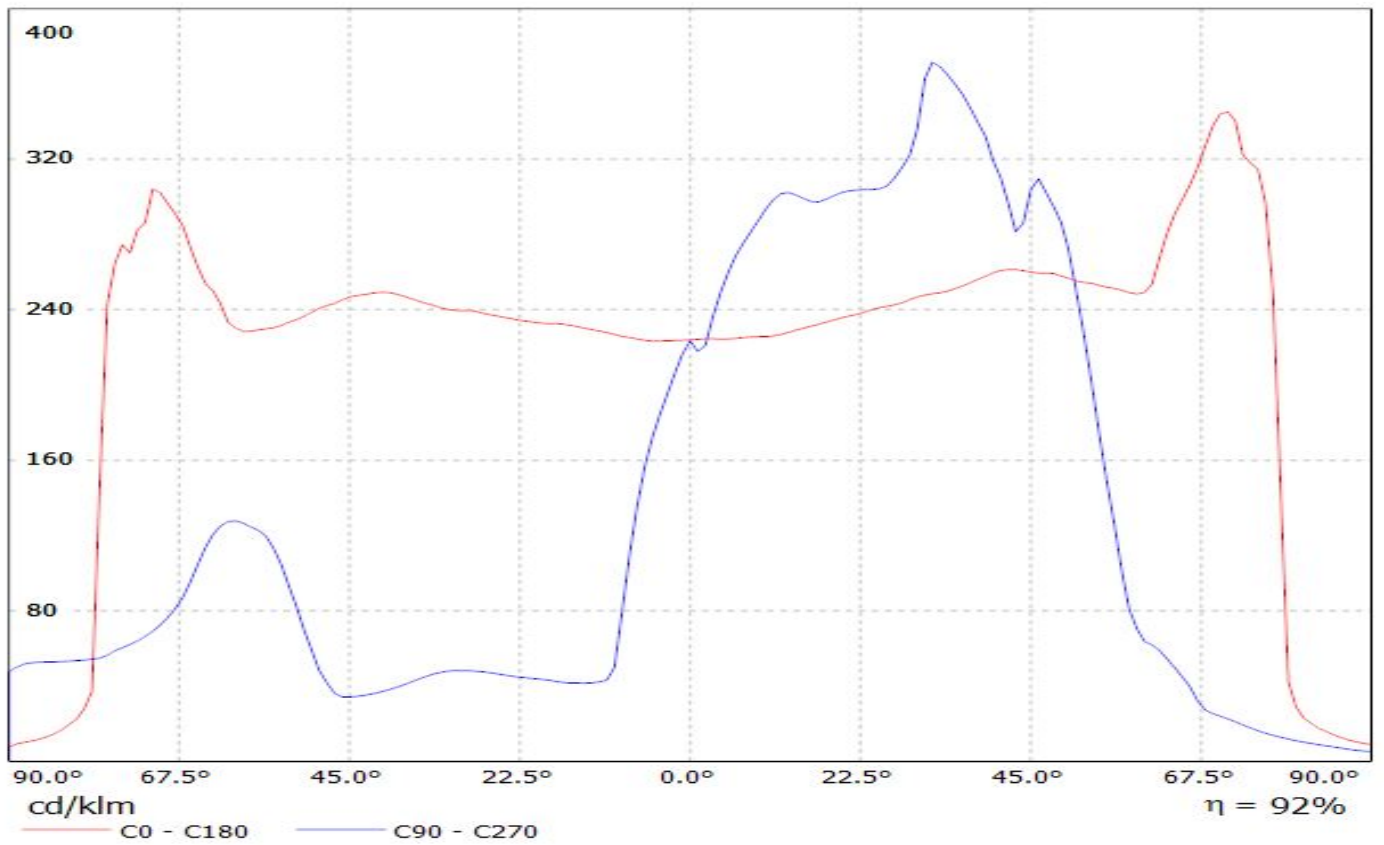

Luminaire: LEDiL Oy CA13688\_STRADA-SQ-T3 (Luxeon\_MZ) Eff: 91%  
Lamps: 1 x LUXEON-MZ\_263.073lm@250mA\_P=2.7399W\_I=249.9mA

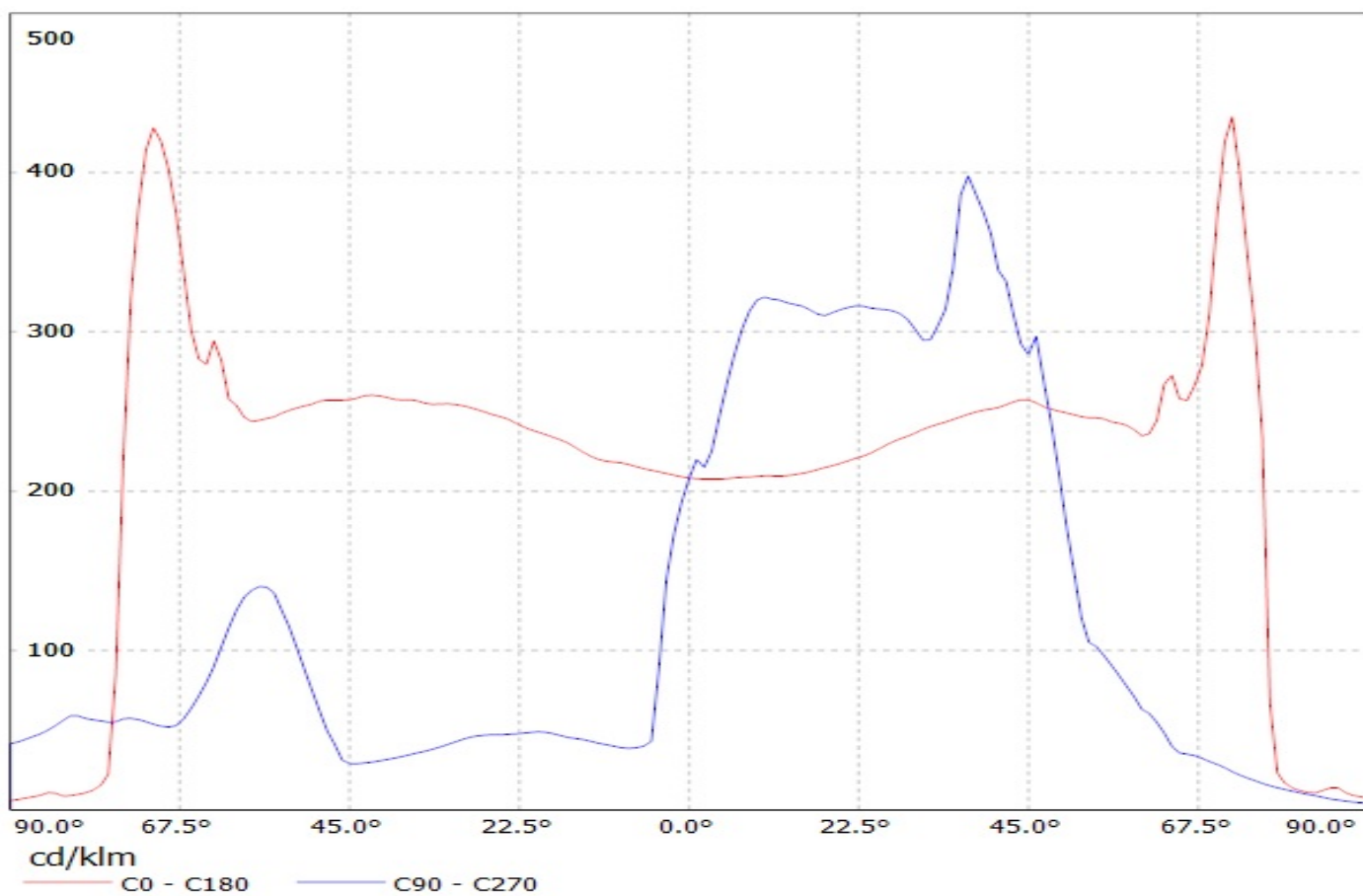

# Ledil CA13688\_STRADA-SQ-T3\_(Luxeon\_TX) / LDC (Linear)

Luminaire: Ledil CA13688\_STRADA-SQ-T3\_(Luxeon\_TX)

Lamps: 1 x Luxeon\_TX\_(L1T2-3585)\_83.3206lm@250mA\_CCT=3554K\_P=0.74W\_I=0.25A

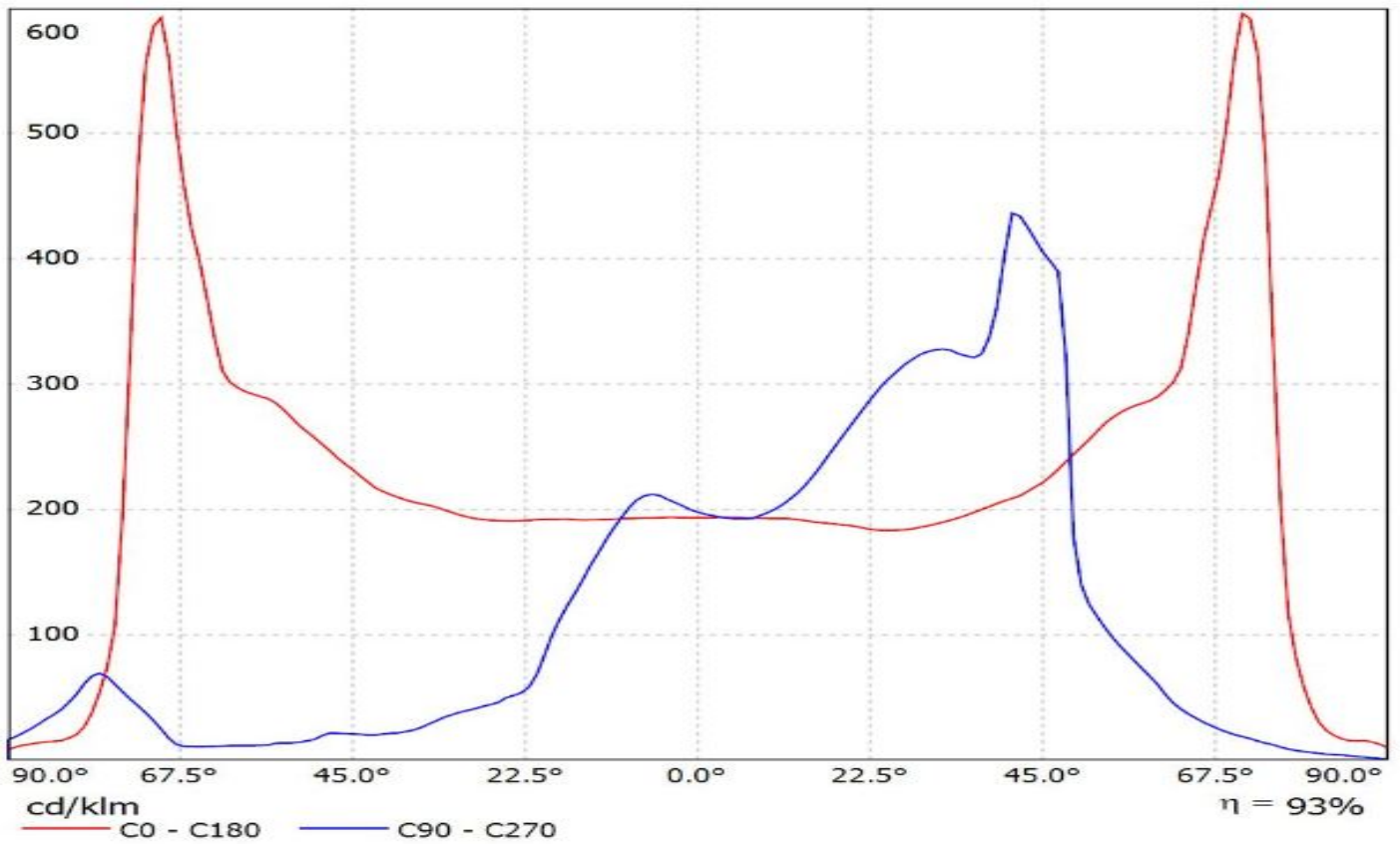

Luminaire: Ledil CA13688\_STRADA-SQ-T3\_(LUXEON\_XR-M\_Linear\_1x4)

Lamps: 1 x Lumiled\_LUXEON\_XR-M\_Linear\_1x4\_1798.32lm@250mA\_P=11.005W\_η=0.25A

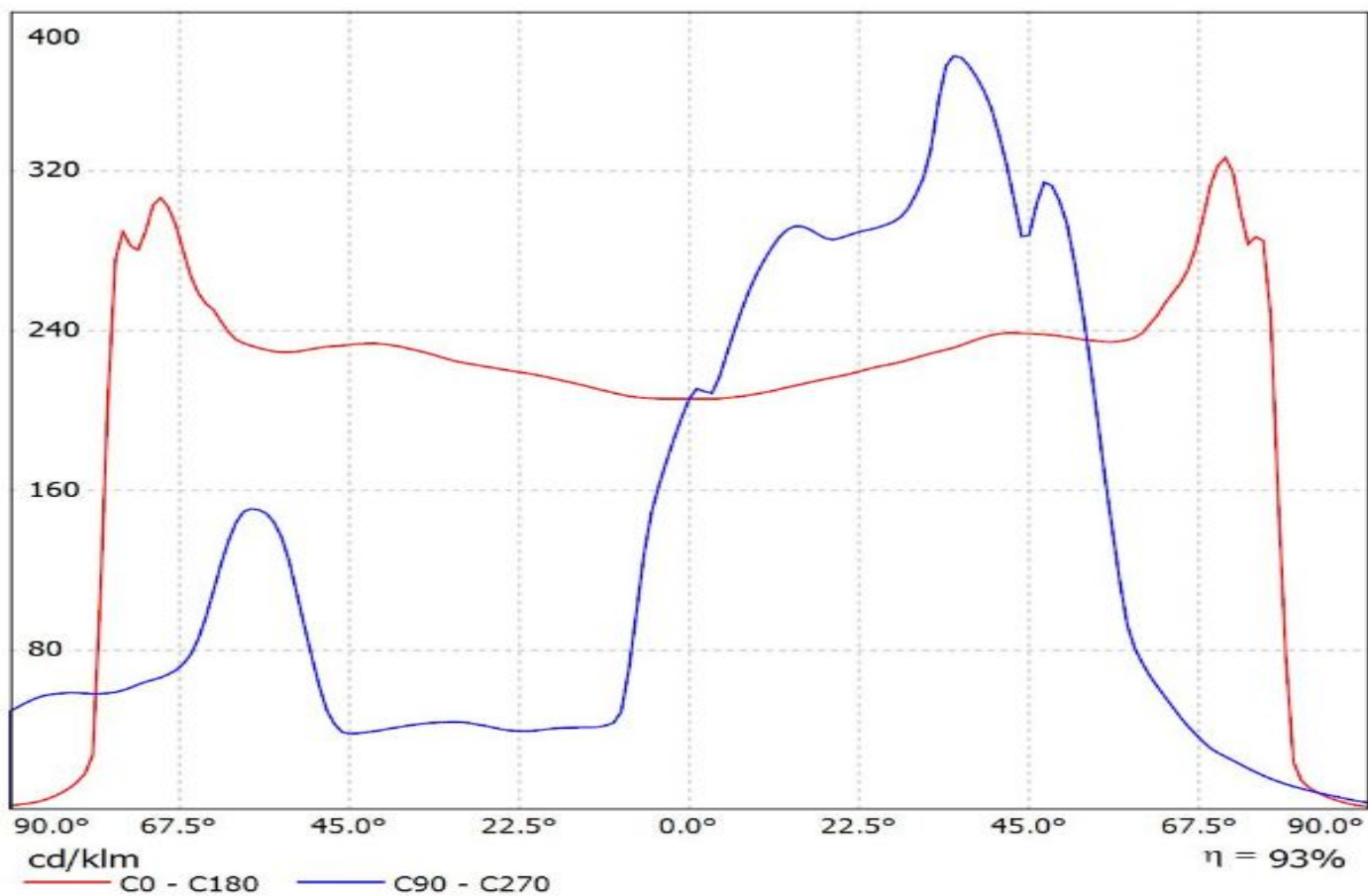



Luminaire: LEDiL Oy CA13688\_STRADA-SQ-T3\_(NV4x144A)  
Lamps: 1 x Nichia\_NV4x144A\_477.906lm@250mA\_P=2.8045W\_I=0.250A

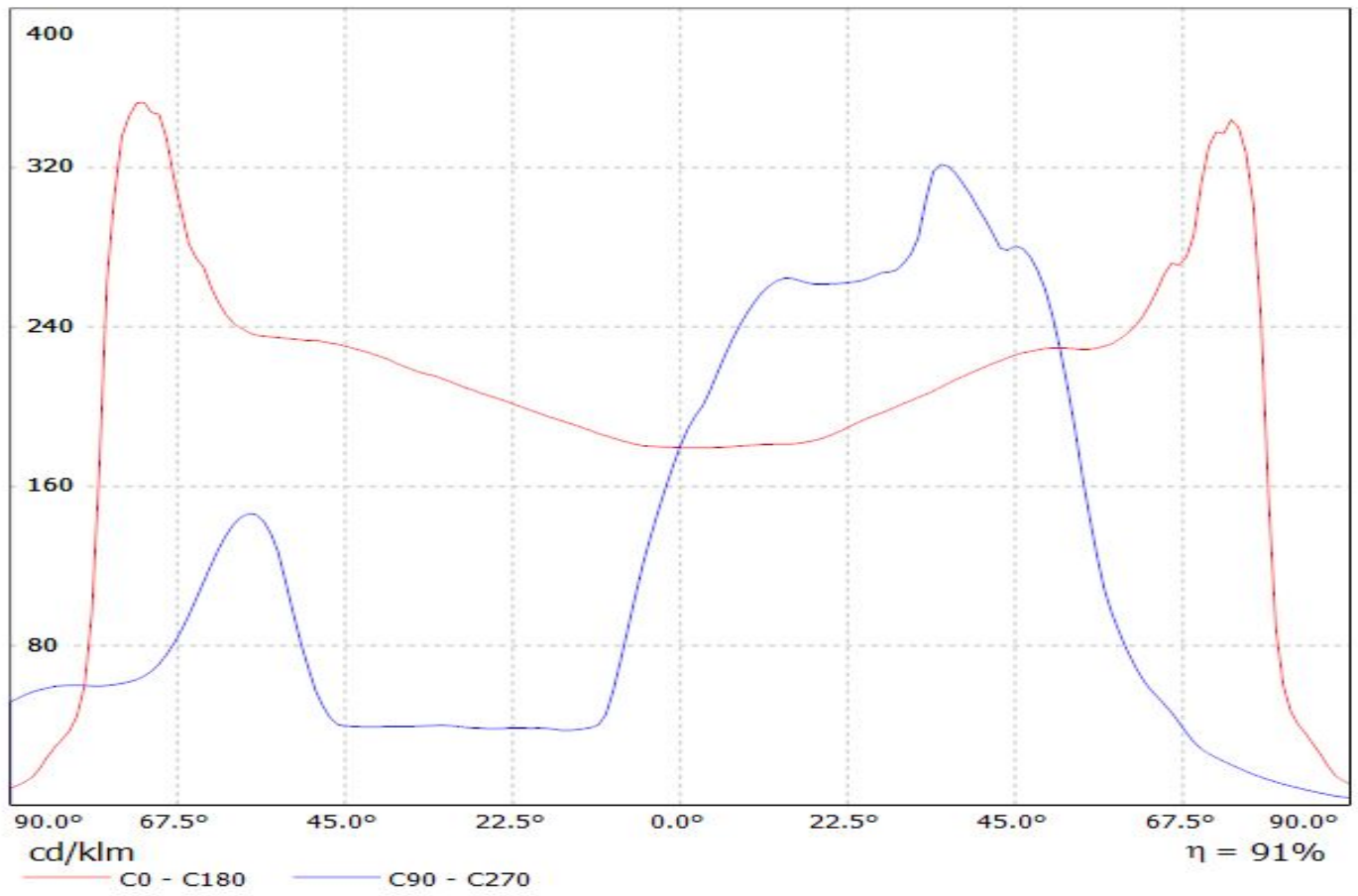

Luminaire: Ledil CA13688\_STRADA-SQ-T3\_(Duris\_S10)

Lamps: 1 x Osram\_Duris\_S10\_(GW-P7LP32.EM)\_992.375lm@250mA\_P=9.2362W\_I=0.25A

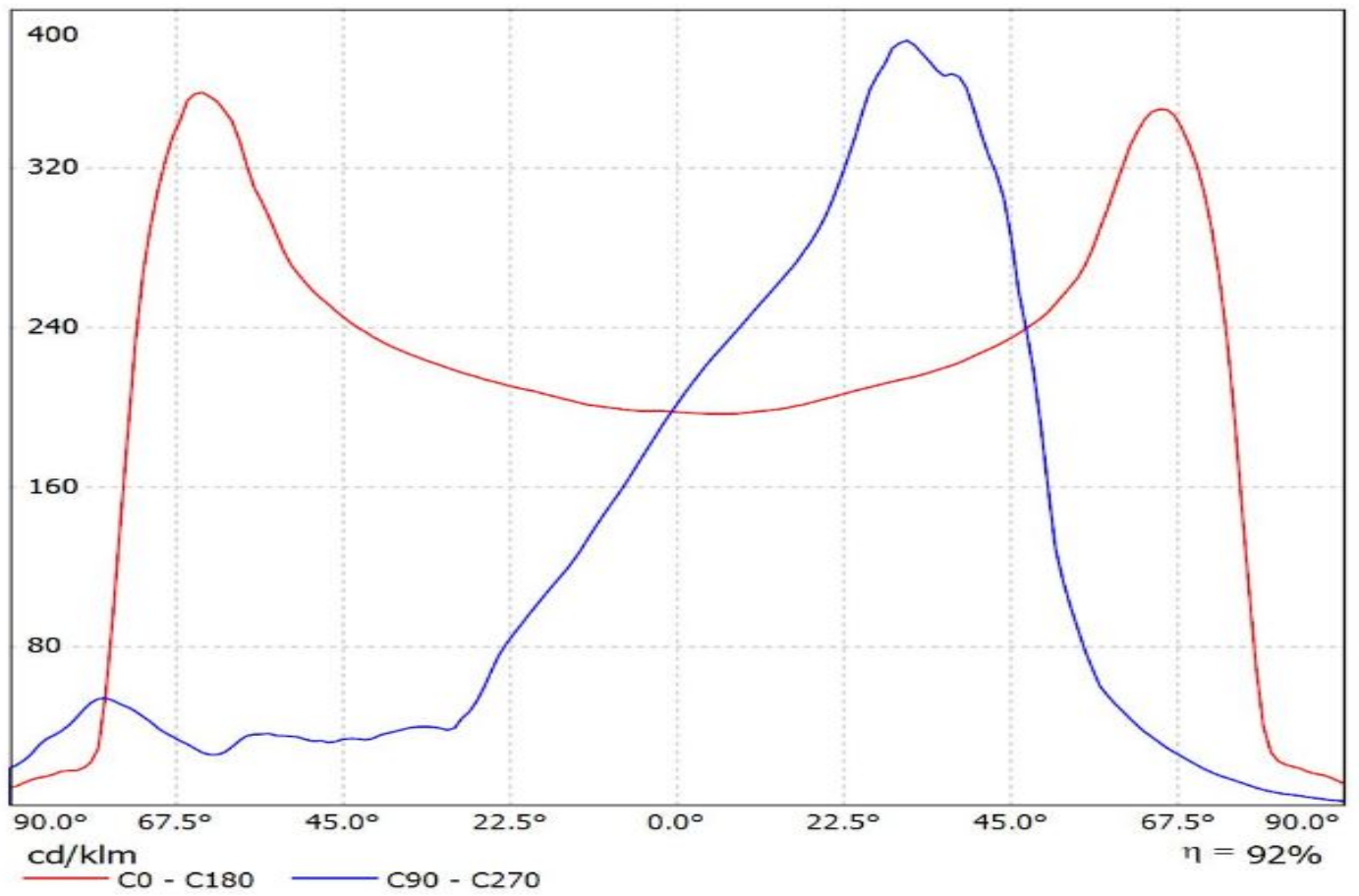

Luminaire: Ledil Oy CA13688\_STRADA-SQ-T3\_(Duris\_P10)  
Lamps: 1 x OSRAM Duris P10

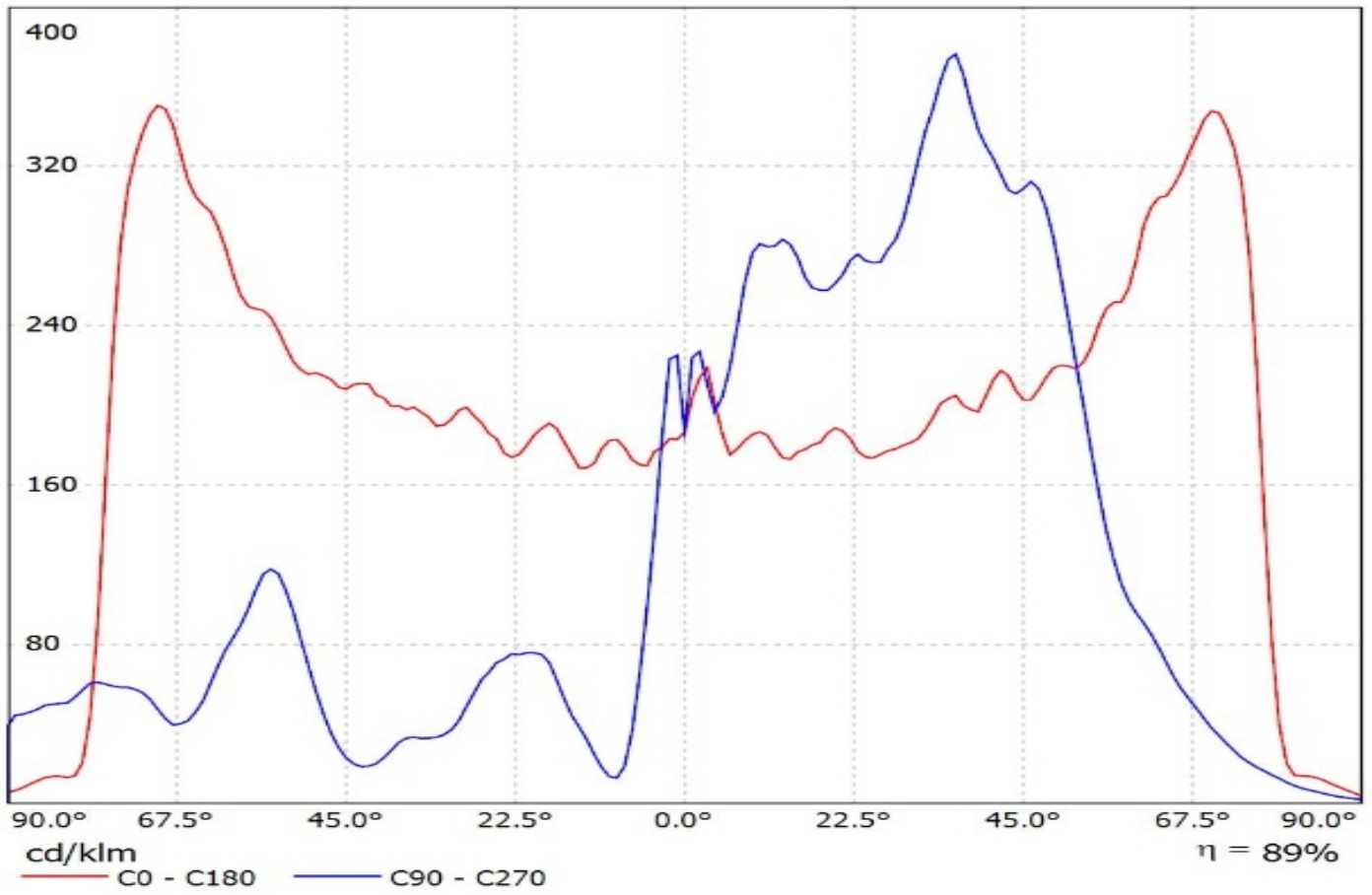

Luminaire: Ledil Oy CA13688\_STRADA-SQ-T3\_(Duris\_P8)\_SIMULATED  
Lamps: 1 x Osram Duris P8 (GW PUSRA1.PM)

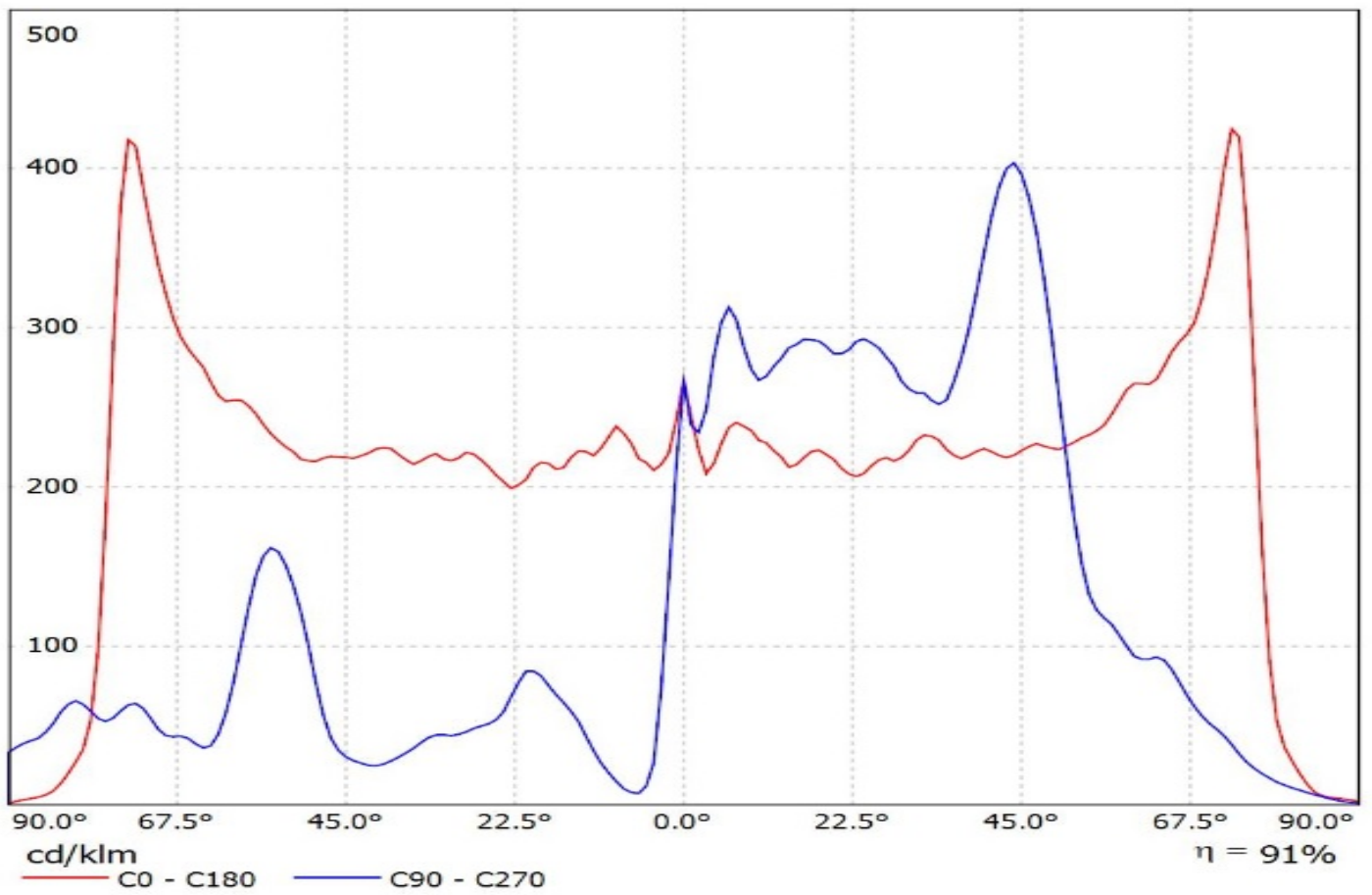

Luminaire: LEDiL Oy CA13688\_STRADA-SQ-T3\_(PSL440)

Lamps: 1 x Citizen\_PSL440\_256.95lm@250mA\_P=2.8697W\_I=0.250A

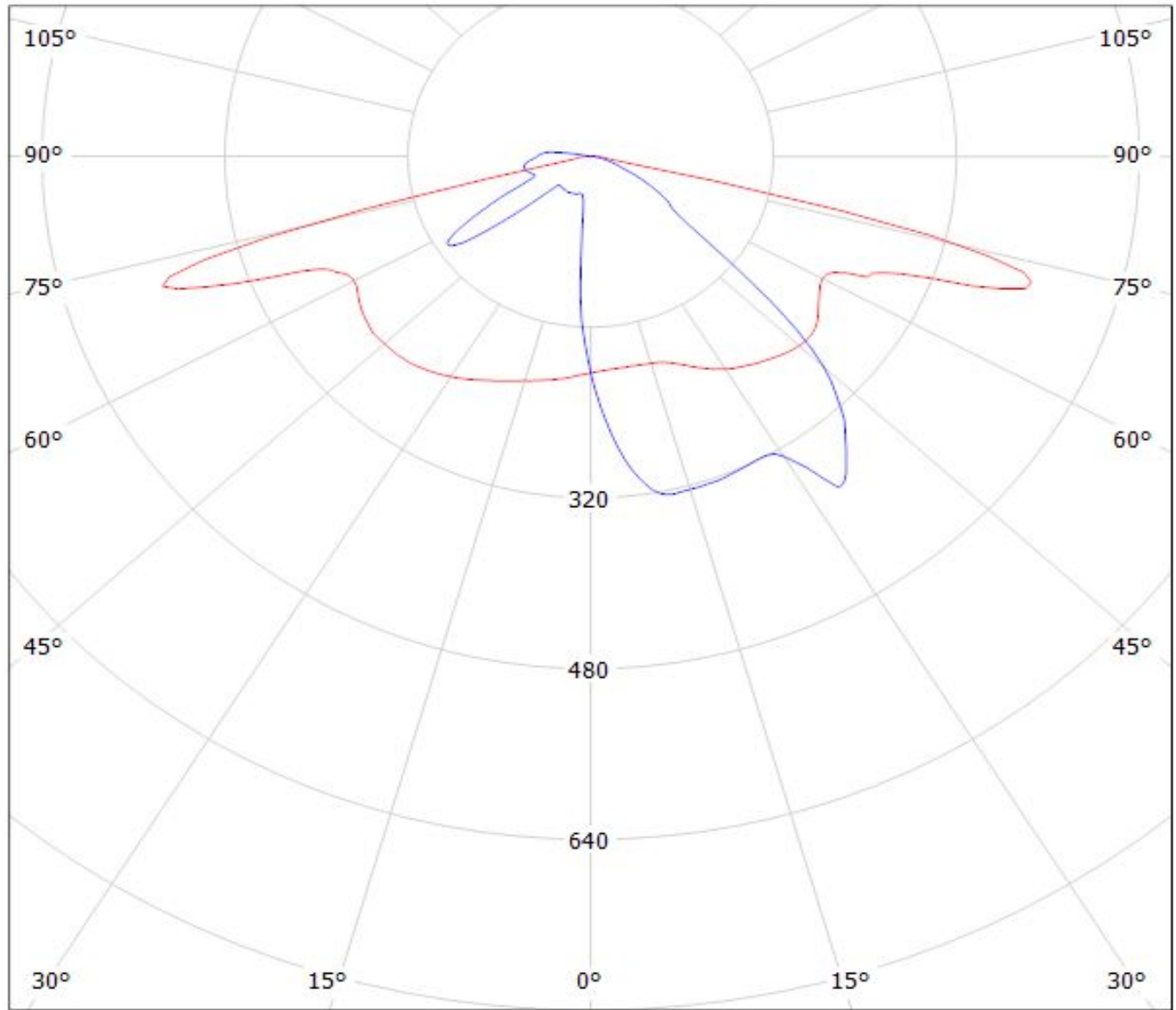

cd/klm

— C0 - C180

— C90 - C270

$\eta = 92\%$

Luminaire: LEDiL Oy CA13688\_STRADA-SQ-T3\_(CREE\_XHP50\_COOLWHITE)  
Lamps: 1 x CREE\_XHP50\_COOLWHITE\_242.798@0.250A\_P=1.42658W\_I=0.2499A

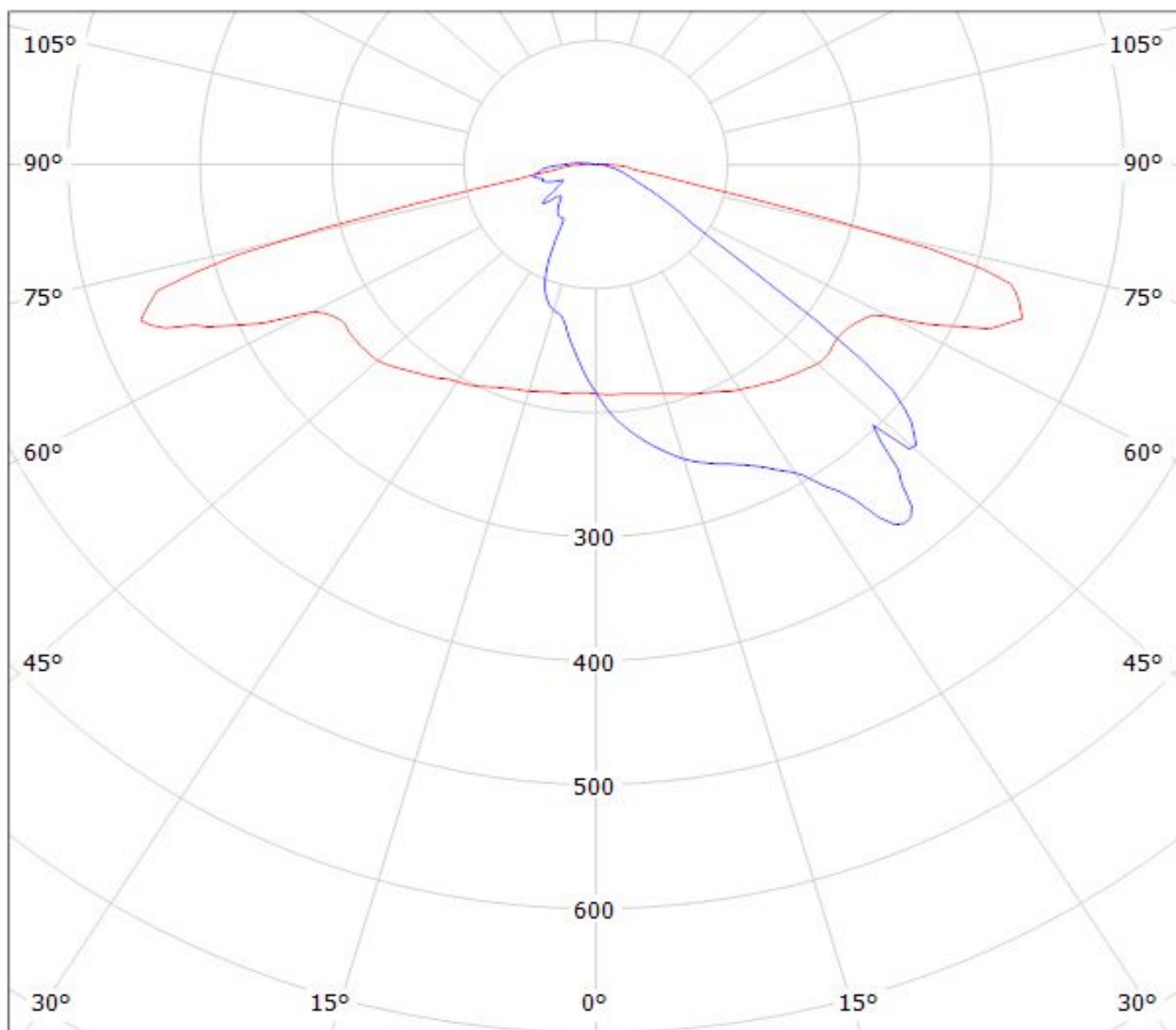

cd/klm

— C0 - C180 — C90 - C270

$\eta = 94\%$

# LEDiL Oy CA13688\_STRADA-SQ-T3\_(LUXEON\_M) Eff.91.7% / LDC (Polar)

Luminaire: LEDiL Oy CA13688\_STRADA-SQ-T3\_(LUXEON\_M) Eff.91.7%

Lamps: 1 x LUXEON\_M\_350.373lm@250mA\_CCT=4092K\_P=2.73116W\_I=249.9mA

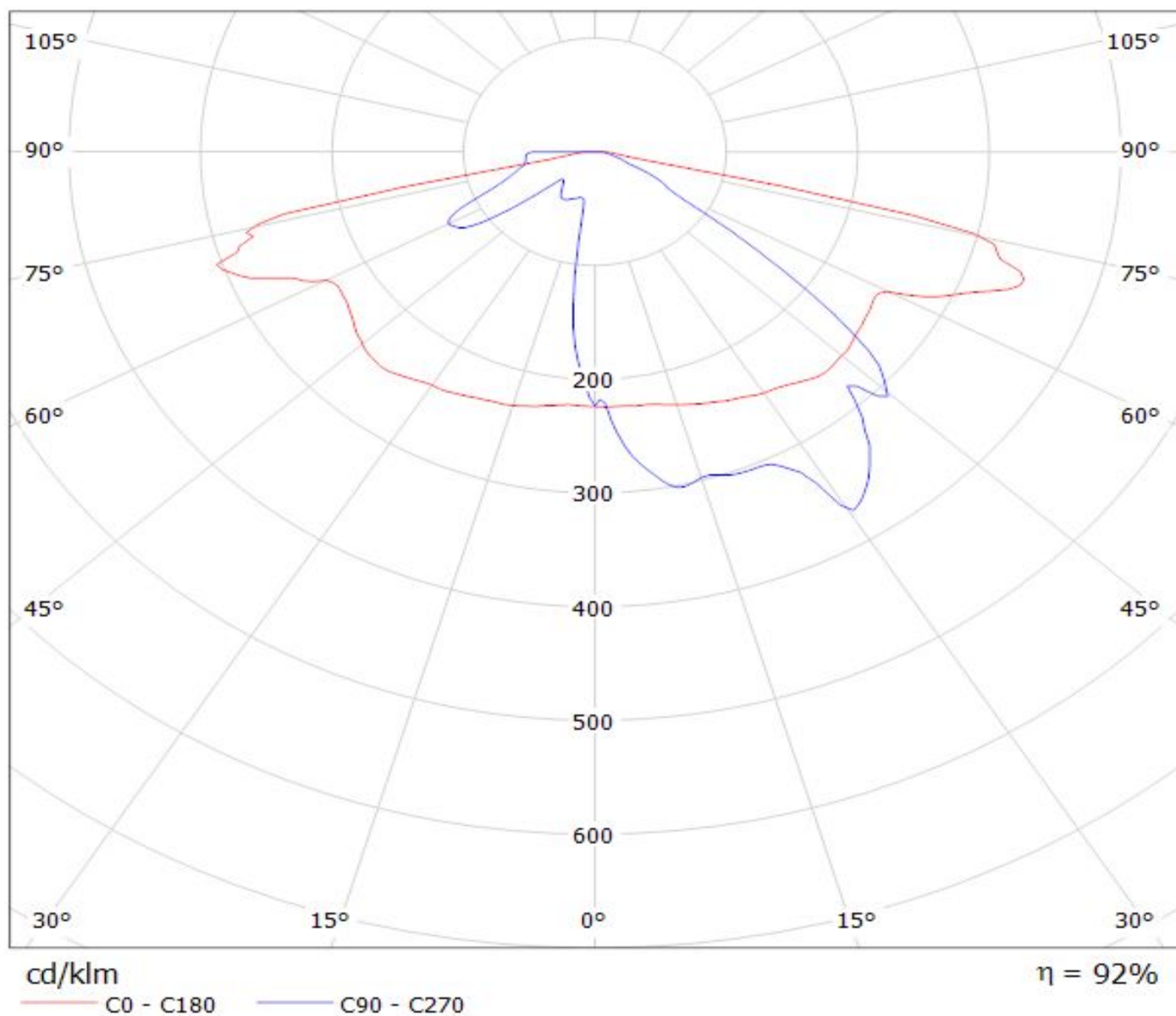

Luminaire: LEDiL Oy CA13688\_STRADA-SQ-T3\_(Luxeon\_MZ) Eff: 91%  
Lamps: 1 x LUXEON-MZ\_263.073lm@250mA\_P=2.7399W\_I=249.9mA

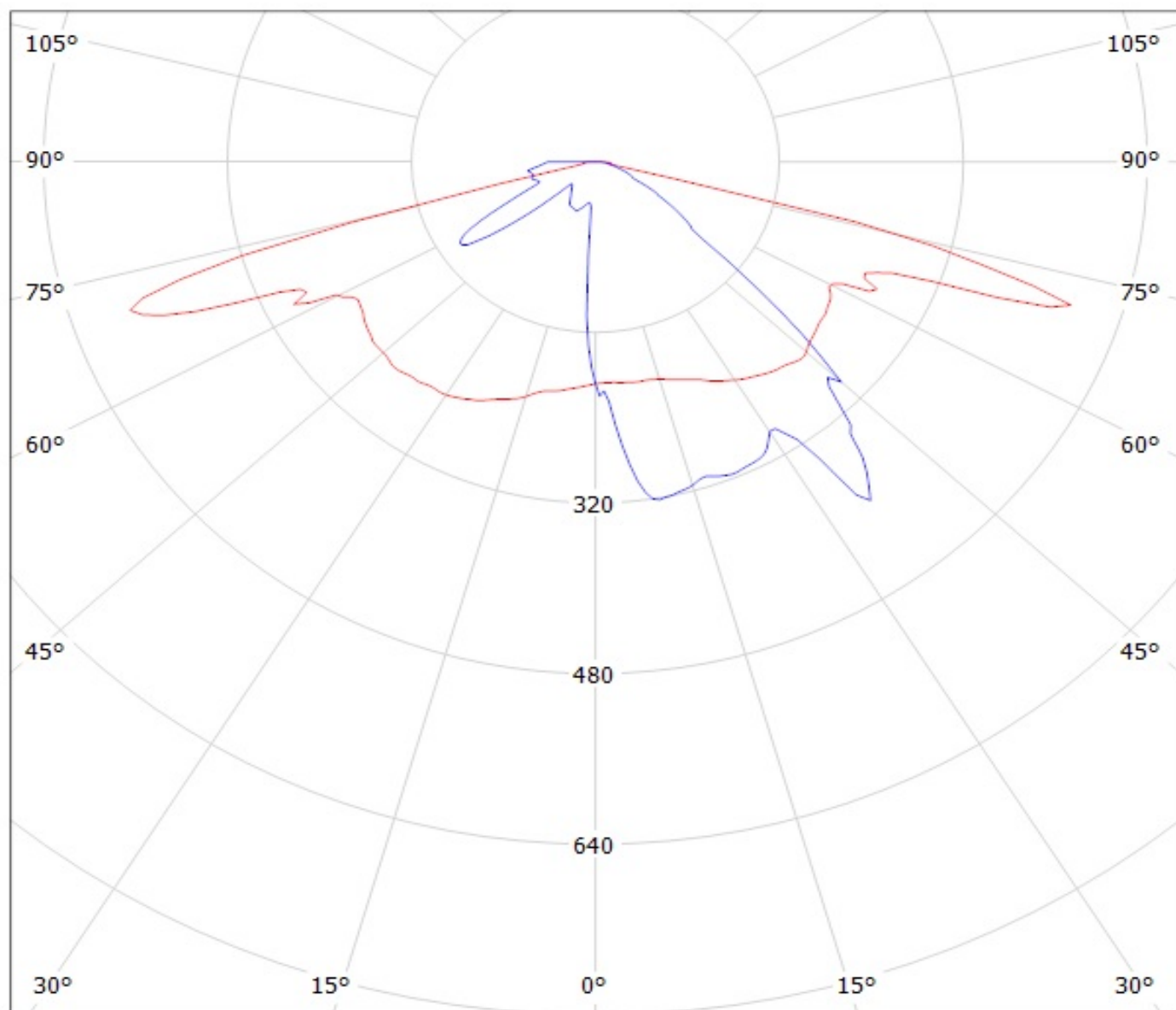

cd/klm

— C0 - C180

— C90 - C270



# Ledil CA13688\_STRADA-SQ-T3\_(Luxeon\_TX) / LDC (Polar)

Luminaire: Ledil CA13688\_STRADA-SQ-T3\_(Luxeon\_TX)

Lamps: 1 x Luxeon\_TX\_(L1T2-3585)\_83.3206lm@250mA\_CCT=3554K\_P=0.74W\_I=0.25A

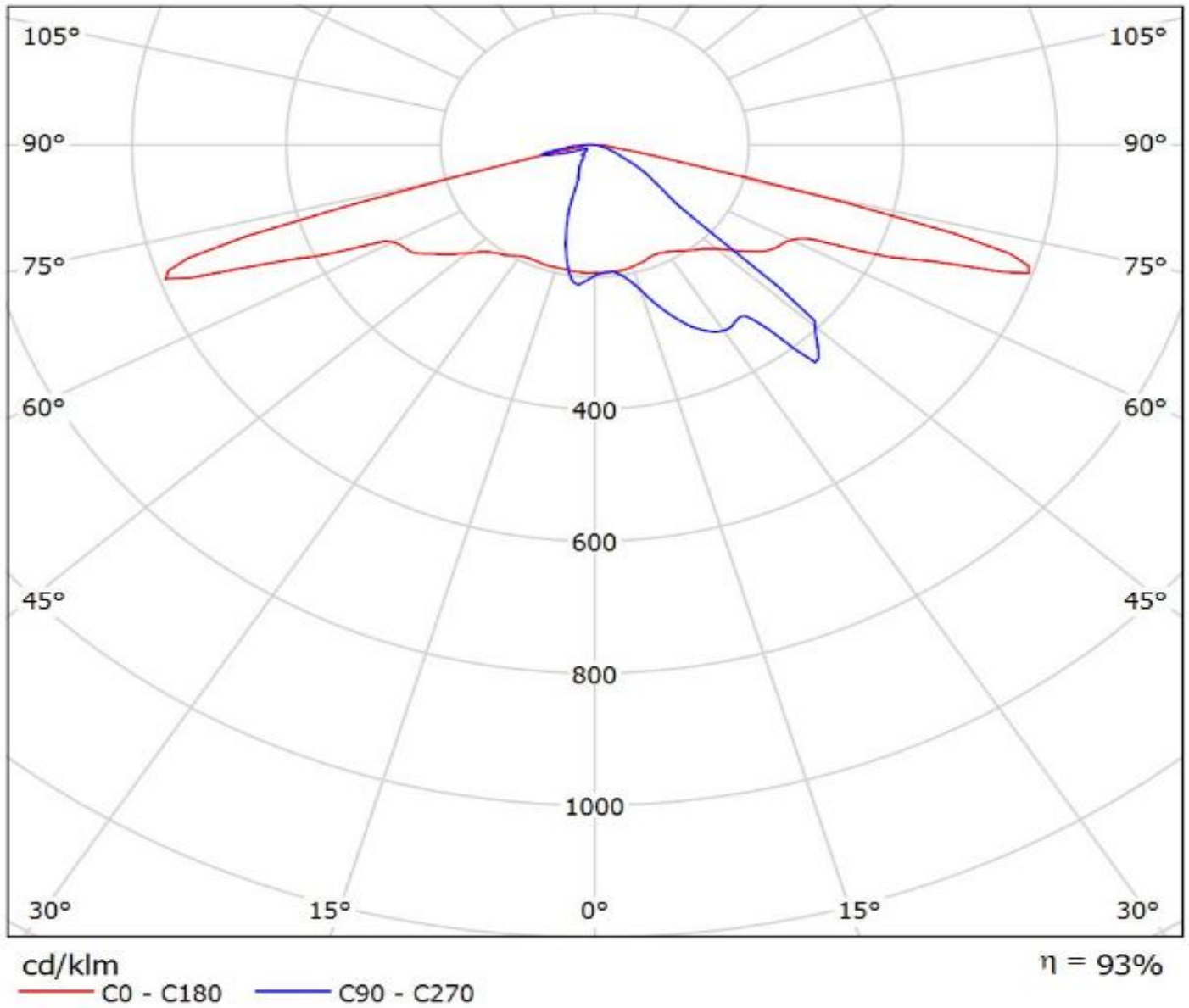

Luminaire: Ledil CA13688\_STRADA-SQ-T3\_(LUXEON\_XR-M\_Linear\_1x4)

Lamps: 1 x Lumiled\_LUXEON\_XR-M\_Linear\_1x4\_1798.32lm@250mA\_P=11.005W\_I=0.25A

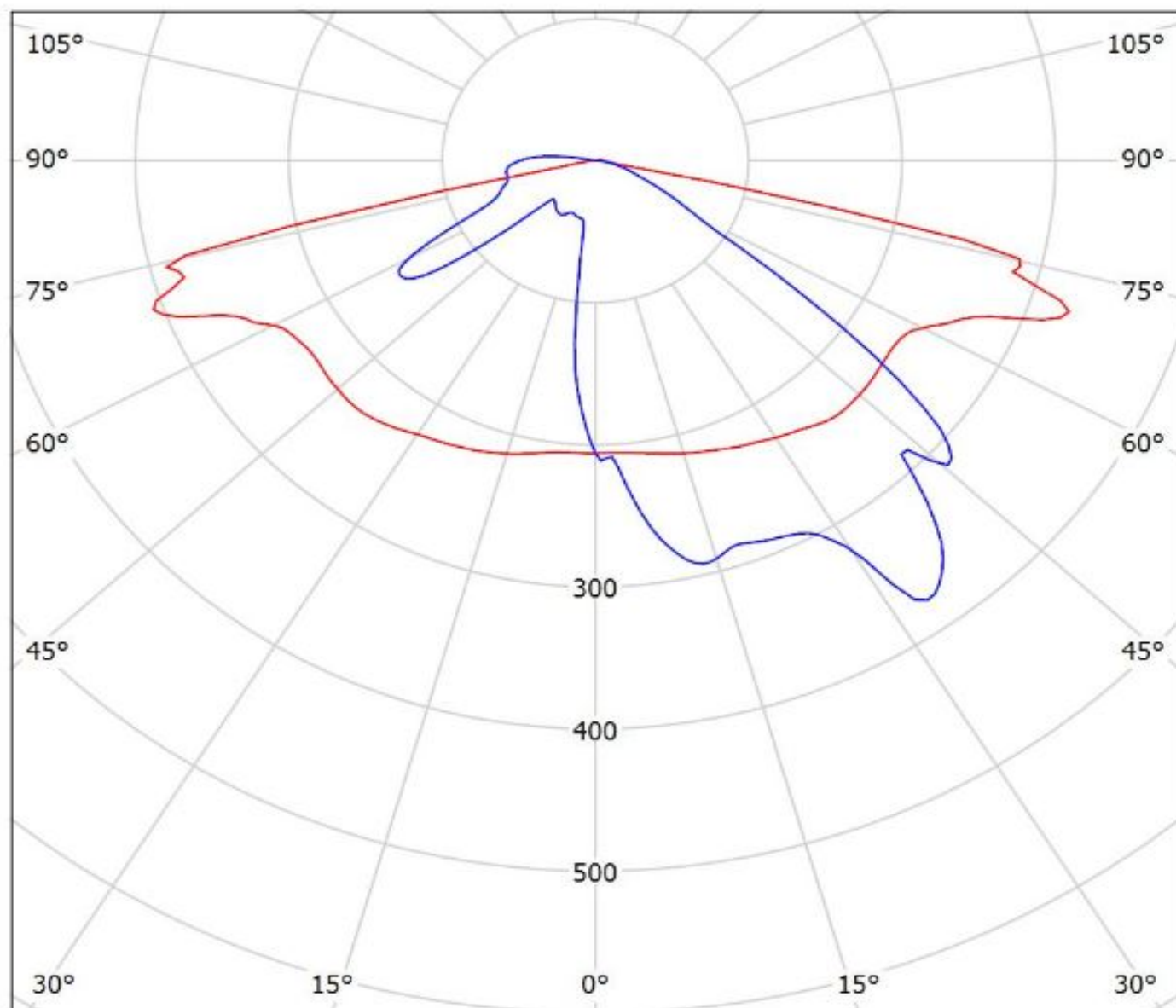

cd/klm

— C0 - C180

— C90 - C270

$\eta = 93\%$

Luminaire: LEDiL Oy CA13688\_STRADA-SQ-T3\_(NV4x144A)

Lamps: 1 x Nichia\_NV4x144A\_477.906lm@250mA\_P=2.8045W\_I=0.250A

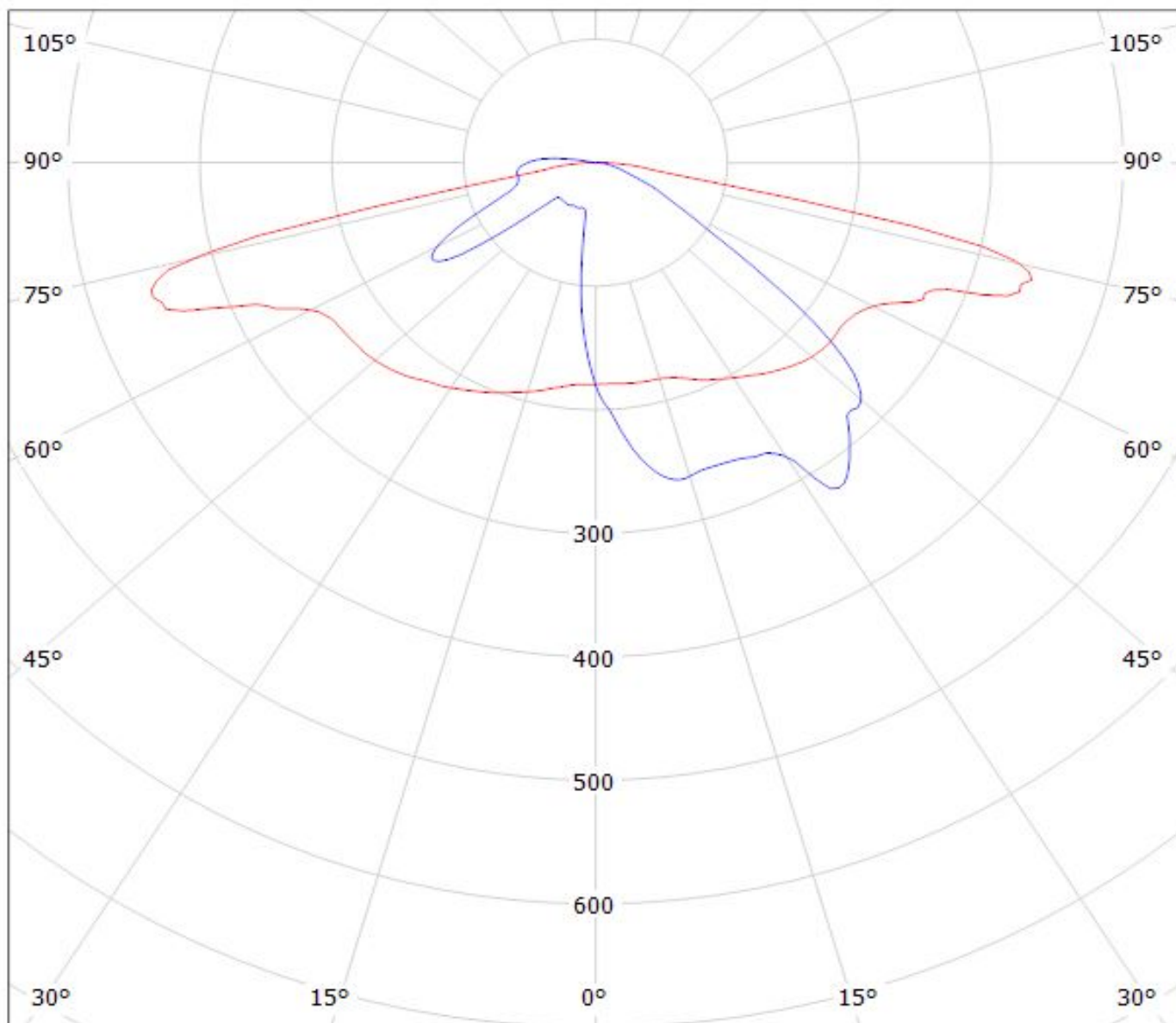

cd/klm

— C0 - C180

— C90 - C270

$\eta = 91\%$

Luminaire: Ledil CA13688\_STRADA-SQ-T3\_(Duris\_S10)

Lamps: 1 x Osram\_Duris\_S10\_(GW-P7LP32.EM)\_992.375lm@250mA\_P=9.2362W\_I=0.25A

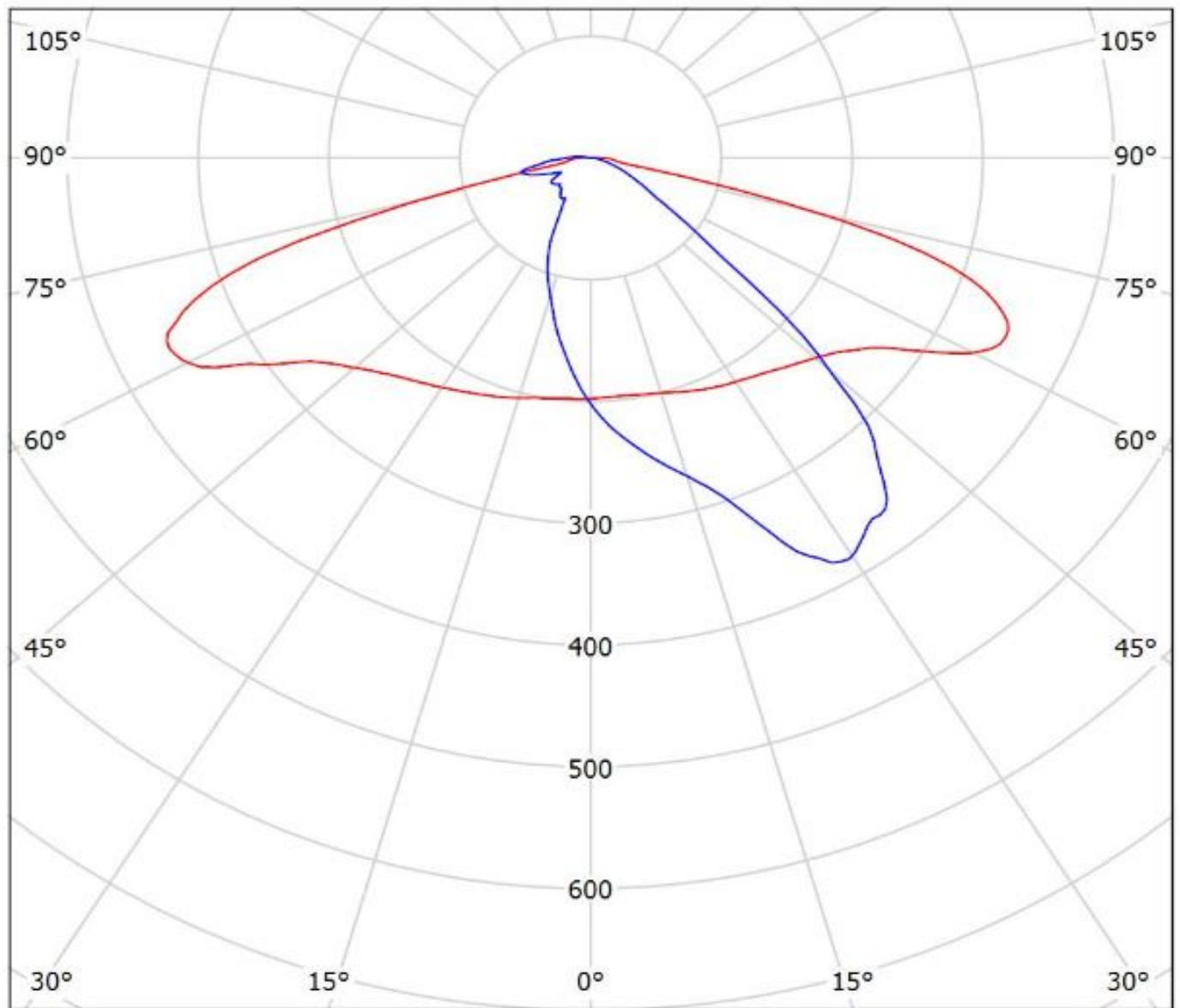

cd/klm

— C0 - C180

— C90 - C270

$\eta = 92\%$

Luminaire: Ledil Oy CA13688\_STRADA-SQ-T3\_(Duris\_P10)  
Lamps: 1 x OSRAM Duris P10

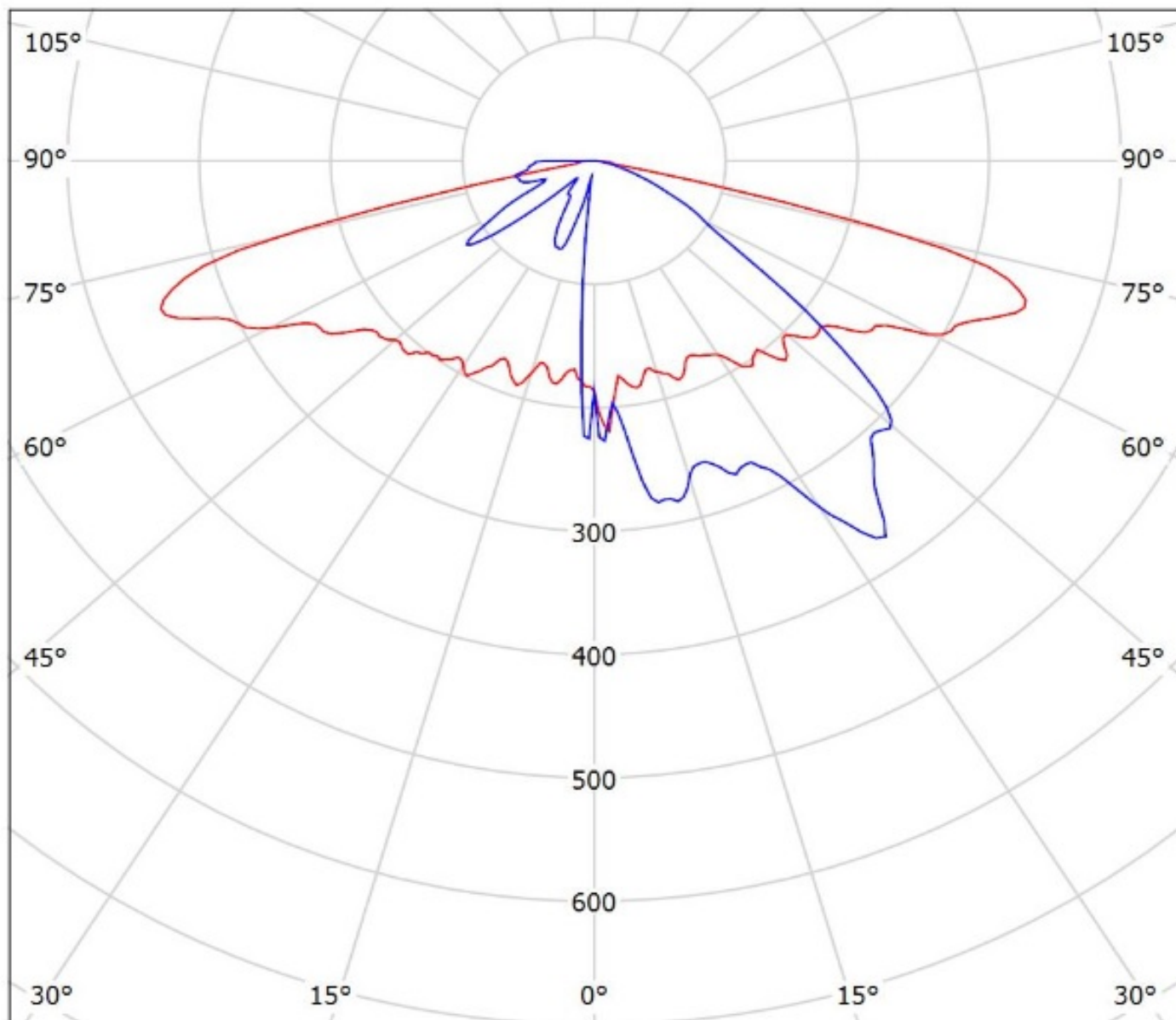

cd/klm

— C0 - C180 — C90 - C270

$\eta = 89\%$

Luminaire: Ledil Oy CA13688\_STRADA-SQ-T3\_(Duris\_P8)\_SIMULATED  
Lamps: 1 x Osram Duris P8 (GW PUSRA1.PM)

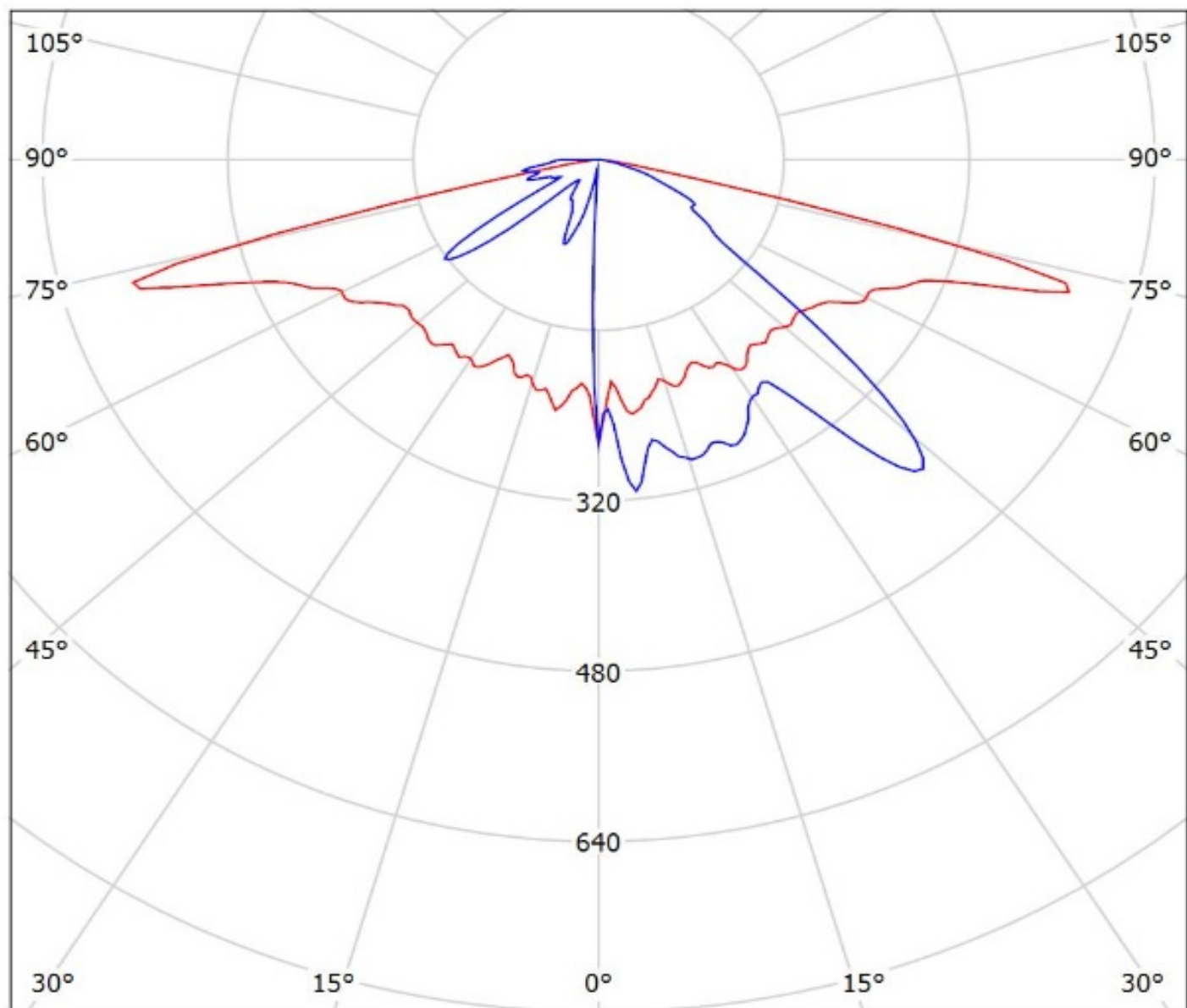

cd/klm

— C0 - C180 — C90 - C270

$\eta = 91\%$

**NOTE: The typical divergence will be changed by different color, chip size and chip position tolerance. The typical total divergence is the full angle measured where the luminous intensity is half of the peak value.**